

QUANTUM PREDATOR 2511

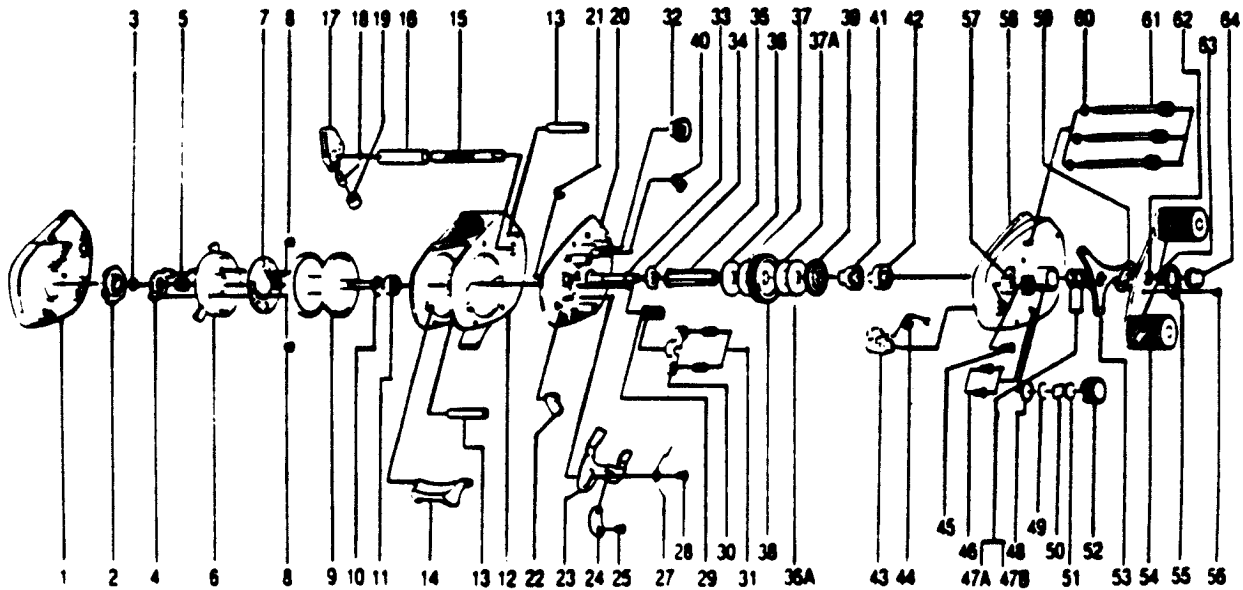

KEY PART NO. NO.	DESCRIPTION	PRICE
1 FW323	LEFT SIDE COVER ASSY.	6.44
2 VX4303	MAGNET CONTROL DIAL	1.43
3 VX4250	DIAL FRICTION RING	.80
4 VX4261	SLIDE CAM	.85
5 VX4301	SLIDE CAM SPRING	.75
6 FW351	SPOOL COVER ASSY.	4.12
7 VX4257	MAGNET PLATE ASSY	12.56
8 VX4602	MAGNET PLATE SCREW	1.68
9 FW321	SPOOL ASSY.	10.82
10 YX4253	CLIP RING	.88
11 YX4252	BALL BEARING	11.78
12 FW001	FRAME	6.70
13 GX4159	CARRIER GUIDE	1.61
14 YX4406	THUMB BAR	5.36
15 YX4151	WORM SHAFT	2.78
16 YX4158	WORM SHAFT GUIDE	4.58
17 FW347	LINE GUIDE CARRIER ASSY.	5.41
18 GX4202	LINE GUIDE PAWL	1.53
19 GX4204	LINE GUIDE CARRIER SCR	1.66
20 YX4351	SET PLATE	8.73
21 GX4665	SHAFT CLIP-E	.46
22 FW036	LINK	1.29
23 GX4402	RELEASE SLIDER	2.12
24 GX4406	THUMB BAR CAM	.92
25 GX4506	LINK SCREW	.69
27 GX4502	SPOOL REL. SPRING	.88
28 GX4656	RELEASE SLIDER SCREW	.88
29 GX4256	PINION GEAR ASSY	2.64
30 GX4401	PINION YOKE	1.09
31 GX4403	PINION YOKE SPR	.88
32 GX4150	OSCILLATOR GEAR	2.93
33 GX4664	SET PLATE SHAFT	1.14
34 GX4655	CONTROL ELEMENT	1.14

KEY PART NO. NO.	DESCRIPTION	PRICE
35 GX4652	CRANK SHAFT	3.44
36 FW048	DRAG WASHER - UPPER	1.70
A36 GX4653	DRAG WASHER "D"	1.72
37 GX4659	DRAG WASHER "B"	1.37
A37 GX4659-1	DRAG W/S B (.8 T)	1.37
38 GX4651	DRIVE GEAR	3.55
39 FW091	ANTI-REVERSE RATCHET	1.44
40 YX4452	ANTI-REVERSE PAWL	3.53
41 FW035	BUSHING - LOWER	5.67
42 FW058	GEAR CLUTCH	5.67
43 FW037	FLIPPIN' ARM	2.06
44 FW089	SPRING - FLIPPIN'	.93
45 WX4510	FLIPP'N LEVER SCREW	1.14
46 GX4352	RIGHT SIDE CVR SCR	1.09
A47 GX4662A	THICK WAVE WASHER	1.34
B47 GX4662B	THIN WAVE WASHER	1.24
48 GX4258	SPOOL TENSION KN. RING	.85
49 GX4302	SPOOL TEN. KN. WSHR.(FL)	.46
50 GX4304	SPOOL TEN. KN. WSHR (SQ)	.46
51 GX4305	SPOOL TEN. KN. WSHR (RB)	.46
52 YX4259	SPOOL TENSION KNOB	3.75
53 FW055	DRAG KNOB	4.38
54 YX4701	HANDLE ASSY.	9.48
55 GX4703	HANDLE NUT LOCK	.85
56 VX4704	HANDLE NUT LOCK SCREW	.92
57 WX4506	FLIPP'N LEVER	1.27
58 FW024	RIGHT SIDE COVER	8.14
59 GX4660	HANDLE WASHER	1.14
60 GX4109	FRAME SCREW WSHR	.46
61 GX4104	FRAME SCREW	1.43
62 GX4105	SET PLATE SHAFT WSHR	.46
63 GX4657	CRANK SHAFT E-CLIP	.46
64 GX4702	HANDLE NUT	.92

Prices subject to change without notice. Prices do not include postage and handling.

PLEASE ORDER BY PART NUMBER

Rev. 11/90

Zebco Division Brunswick Corporation, Box 270, Tulsa, OK 74101 USA 918-638-6881

